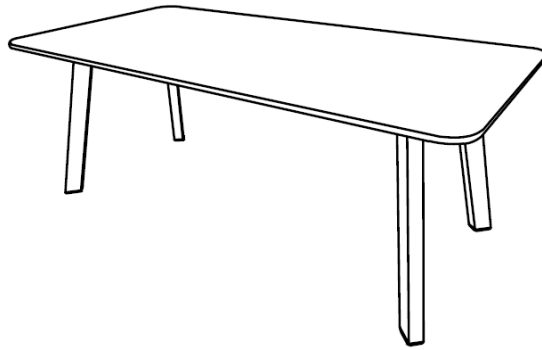

Table Instructions



Pre-Assembly Preparation

15 Minutes
Assembly

Floor space
Needed: 1.5m²

1 Person
Assembly

Part List



A - Table Top x1

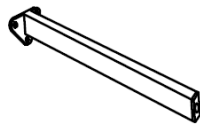

B - Adjustable
Leg x2

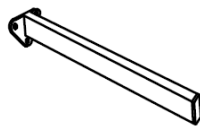

C – Table Leg x2



D – Allen Key x12

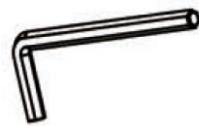

E – Allen Key x1

Pre-Assembly Instructions

1. Please check that all parts are present before you start the assembly of your furniture, as once assembled, the furniture is exempt from our home approval policy.
2. For ease and speed of assembly, we recommend that before you commence each step of the assembly, that you identify all the parts required for that step.
3. For large items, please ensure that you have sufficient space and people to assemble your product safely.
4. We recommend that, where possible, all items are assemble near the area in which they will be placed in use, to avoid moving the product unnecessarily once assembled.
5. Do not completely tighten bolts until all the bolts are properly fitted.
During assembly please take care not to over-tighten any fittings, as this may damage the product. Do not use any power tools.

Step 1

Take out all the components and place them onto a soft, clean surface.

Place the table top (A) upside down and attach the 2x adjustable legs (B) to one side of the table. Place Bolts (D) into the holes, only hand tighten at this stage.

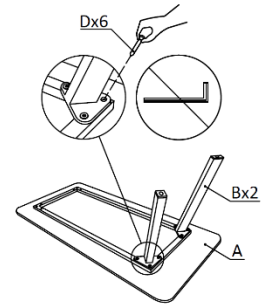

Step 2

Line up the table leg (C) with the table top. Place Bolts (D) into the holes, only hand tighten at this stage.

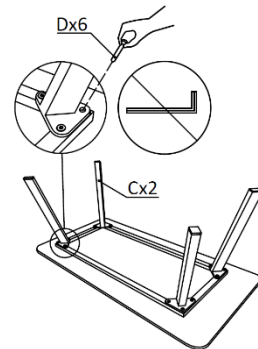

Step 3

Take the allen key (E) and tighten all bolts.

Turn the table the correct way up, it is now ready to use.

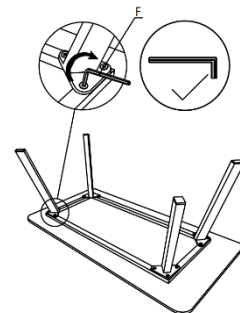

Care & Maintenance Of Your Furniture

- Please periodically check all fittings are re-tightened as necessary.
- Please do not drag or pull your furniture as this may damage it.
- To clean, wipe with a damp cloth, do not use bleach, acid solvents or abrasive cleaners for frame parts. Dry with a dry clean soft cloth.
- A furniture cover is recommended to extend the lifespan of the product.
- The cushion is not waterproof and should be stored in a dry area when not in use.
- During varying weather conditions and winter period, we recommend that it is stored in a dry area. Please ensure that it is clean and dry.
- In the event the metal frame is scratched exposing bare metal, treat with a rust repelling paint to avoid rusting.